

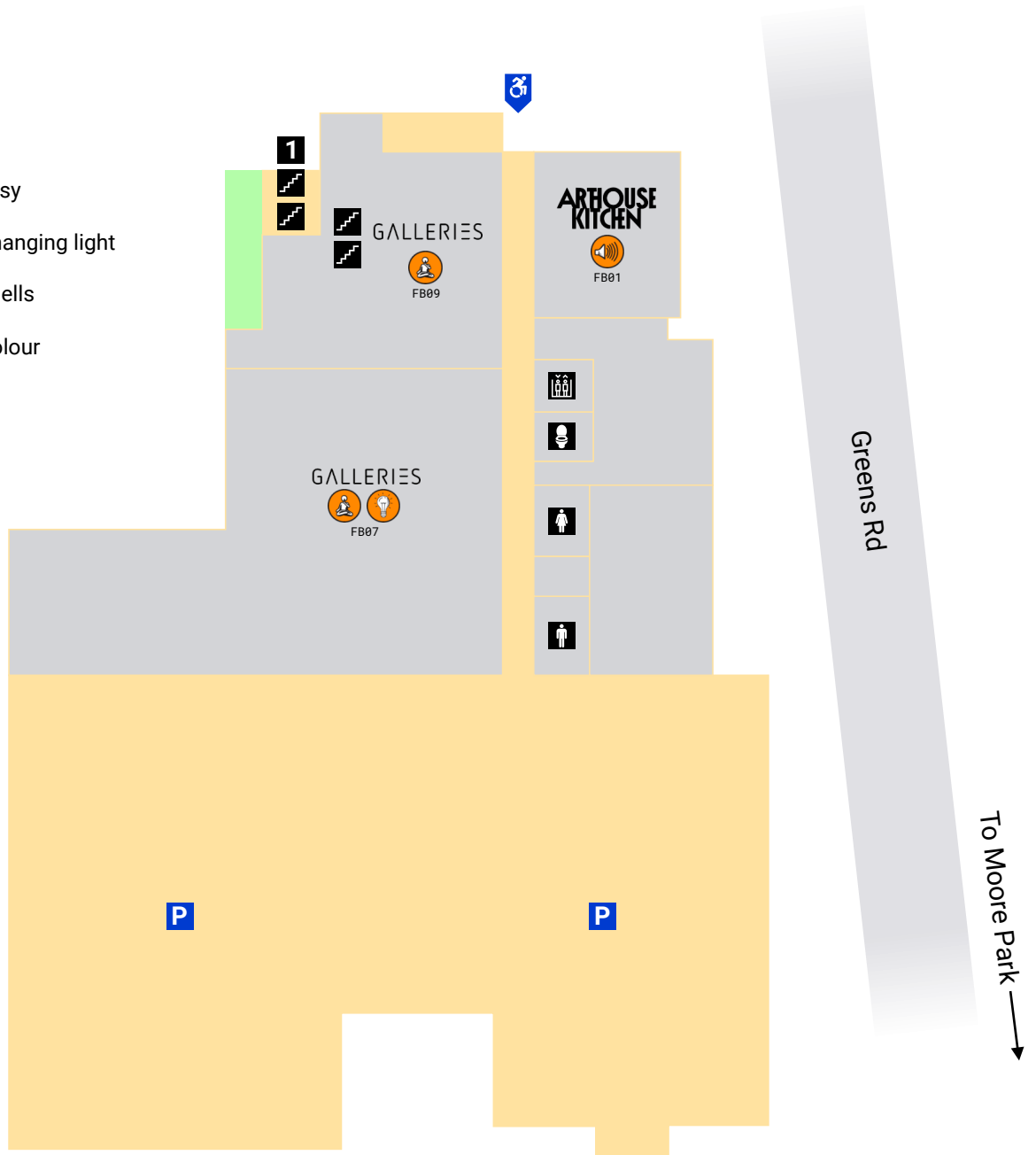

## Block F - Basement

- Quiet area
- Loud / noisy
- Bright / changing light
- Strong smells
- Intense colour



- |                    |                    |             |
|--------------------|--------------------|-------------|
| Parking            | Toilets            | Shuttle bus |
| Accessible parking | All gender toilets | Bike rack   |
| Accessible gate    | Elevator           | Entry gate  |
| Ramp               | Stairs             | Help point  |



# Paddington Campus Sensory Map

11/01/2023

## Block F - Ground Floor

- Quiet area
- Loud / noisy
- Bright / changing light
- Strong smells
- Intense colour

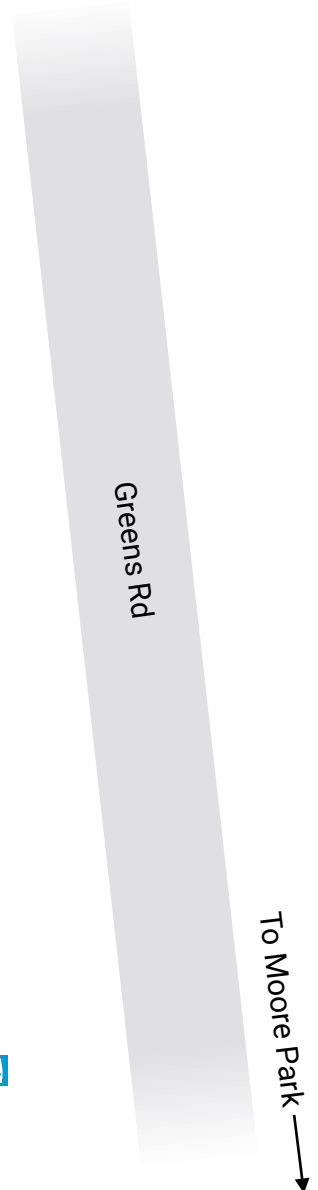
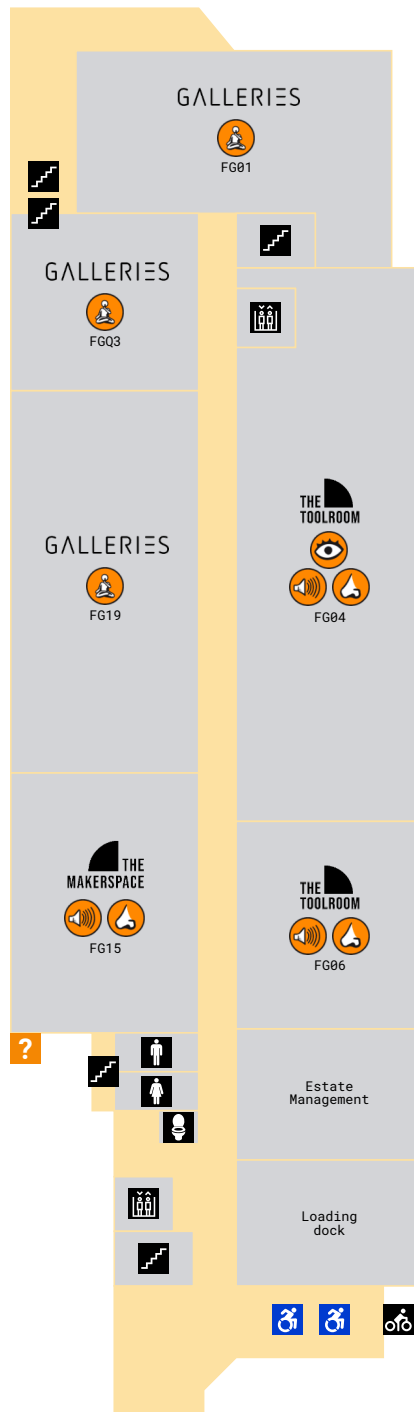

- |                    |                    |             |
|--------------------|--------------------|-------------|
| Parking            | Toilets            | Shuttle bus |
| Accessible parking | All gender toilets | Bike rack   |
| Accessible gate    | Elevator           | Entry gate  |
| Ramp               | Stairs             | Help point  |





## Block F - First Floor

- Quiet area
- Loud / noisy
- Bright / changing light
- Strong smells
- Intense colour

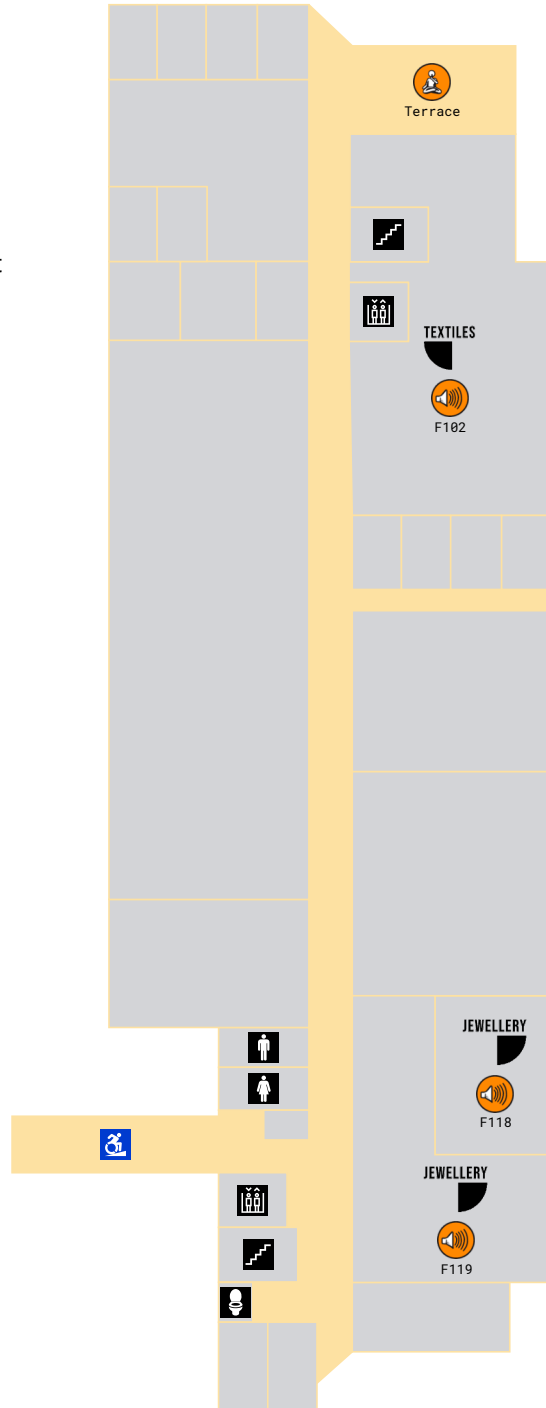

- |                    |                    |             |
|--------------------|--------------------|-------------|
| Parking            | Toilets            | Shuttle bus |
| Accessible parking | All gender toilets | Bike rack   |
| Accessible gate    | Elevator           | Entry gate  |
| Ramp               | Stairs             | Help point  |





## Block F - Second Floor

- Quiet area
- Loud / noisy
- Bright / changing light
- Strong smells
- Intense colour

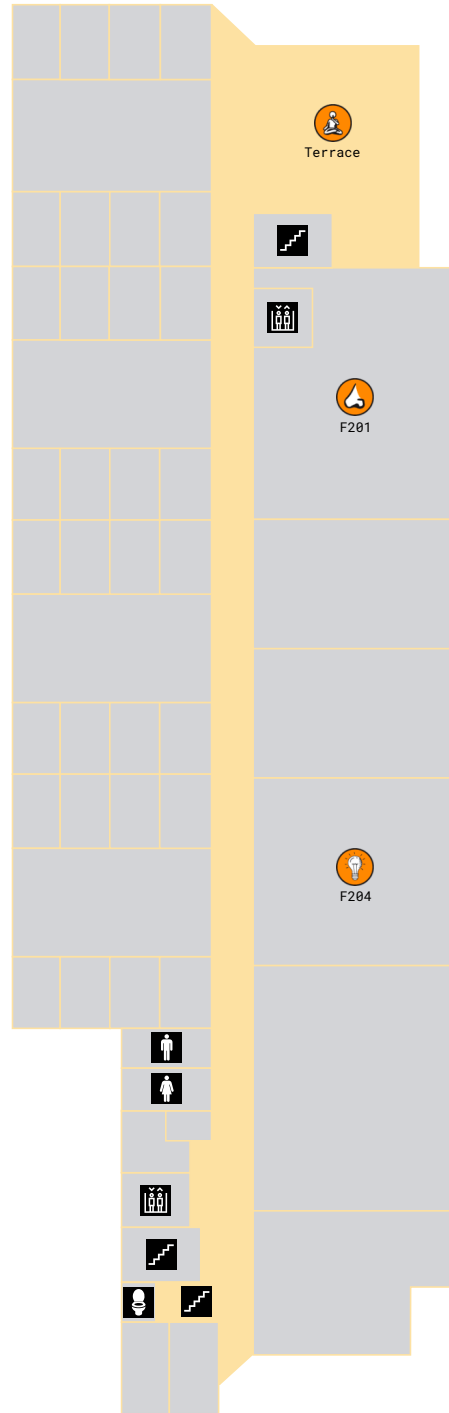

- |                    |                    |             |
|--------------------|--------------------|-------------|
| Parking            | Toilets            | Shuttle bus |
| Accessible parking | All gender toilets | Bike rack   |
| Accessible gate    | Elevator           | Entry gate  |
| Ramp               | Stairs             | Help point  |





## Block F - Third Floor

- Quiet area
- Loud / noisy
- Bright / changing light
- Strong smells
- Intense colour

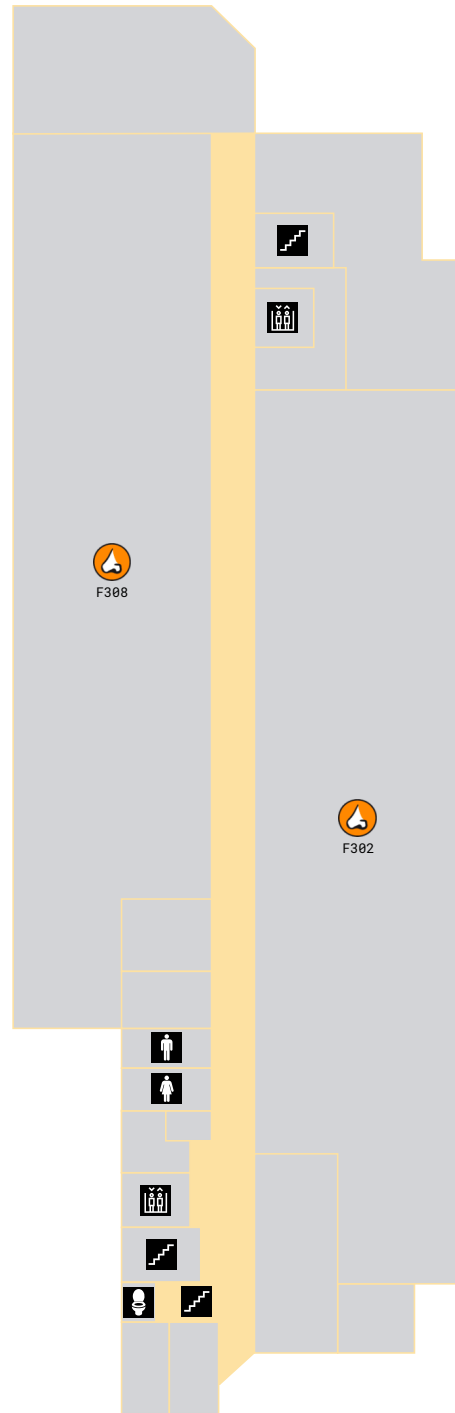

- |                    |                    |             |
|--------------------|--------------------|-------------|
| Parking            | Toilets            | Shuttle bus |
| Accessible parking | All gender toilets | Bike rack   |
| Accessible gate    | Elevator           | Entry gate  |
| Ramp               | Stairs             | Help point  |





## Block F - Fourth Floor

- Quiet area
- Loud / noisy
- Bright / changing light
- Strong smells
- Intense colour

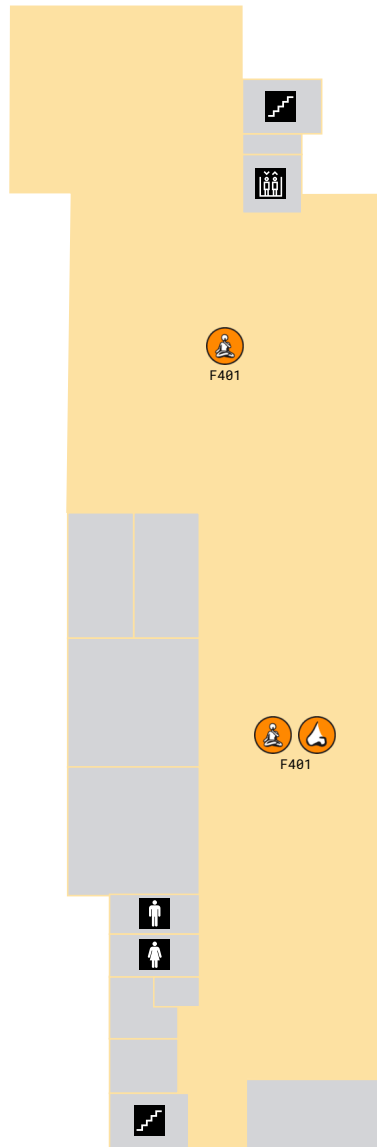

- |                    |                    |             |
|--------------------|--------------------|-------------|
| Parking            | Toilets            | Shuttle bus |
| Accessible parking | All gender toilets | Bike rack   |
| Accessible gate    | Elevator           | Entry gate  |
| Ramp               | Stairs             | Help point  |

