

30
double-sided
adhesive tape

60
wires
24AWG UL1571

50
connector
JST PHR-3

40
adhesive tape kapton

20
PCM

10
LP1260100

40
adhesive tape
kapton (2x)

12.0^{+0,3}
-0,3

60^{+0,5}
-0,5

101^{+1,0}
-1,0

100^{+3,0}
-3,0

Specification

Lithium Polymer Battery Pack LP1260100 10000mAh 3.7V with Protection Circuit Module (PCM)
This data sheet describes the requirements and properties of lithium polymer rechargeable battery pack manufactured by LiPol Battery Co., Ltd - China

Mechanical Characteristics

| | |
|---------------|----------------------|
| Cell | ▶ LP1260100 |
| PCM | ▶ Yes |
| NTC | ▶ 10KΩ 1% +25C B3435 |
| Configuration | ▶ 1S1P |
| Weight | ▶ appr. 200g |
| Connector | ▶ JST PHR-3 |

Electrical Specification

| | |
|--|-------------------------------|
| Rated Capacity | ▶ 10000mAh min, 10050mAh typ. |
| Nominal Voltage | ▶ 3.7V |
| Wat-Hour Rating | ▶ 37Wh |
| Max. Operating Voltage Range | ▶ 2.75V to 4.20V |
| Max. Charge Voltage | ▶ 4.2V ±50mV |
| Max. Charge Current | ▶ 2000mA |
| Standard Charge Current | ▶ 1000mA |
| Max. Continuous Discharge Current | ▶ 3000mA |
| Standard Discharge Current | ▶ 1500mA |
| Discharge Cut Off | ▶ 2.75V |
| Internal Impedance | ▶ <200mΩ |
| Expected Cycle Life @ (0.5C/0.5C) @ 23±5°C | ▶ 500 cycles ≥ 80% |

Cell Protection

| | |
|-------------------------|--|
| Overcharge Detection | ▶ 4.275 ±50mV (0.7 to 1.3sec. delay, release 4.275V ±50mV) |
| Overdischarge Detection | ▶ 2.75V ±50mV (14 to 26msec. delay, resume 2.50V ±50mV) |
| Overcurrent Detection | ▶ 4A to 4.5A (8 to 16msec. delay) |

Ambient Conditions

| | |
|-----------------------|----------------------------------|
| Charge Temp. Range | ▶ +10°C to +45°C |
| Discharge Temp. Range | ▶ -20°C to +60°C |
| Storage Temp. Range | ▶ 1 year at -20°C to +30°C >70% |
| | ▶ 3 moths at -20°C to +45°C >70% |
| | ▶ 1 month at -20°C to +60°C >70% |

Environmental and Safety

Please follow LiPol Handling and Safety Precautions for Lithium Polymer Battery. This battery meets the requirements of Battery Directives, and the battery parts are IEC62133-2-2017 & RoHS-Compliant. For more safety precautions and performance standards, please go to www.lipolbattery.com/support.html

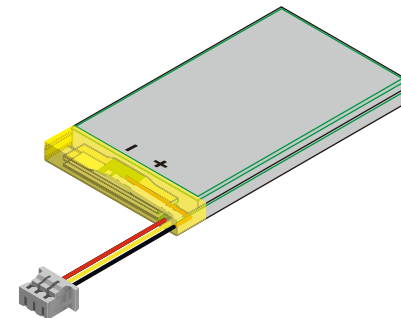

Circuit diagram

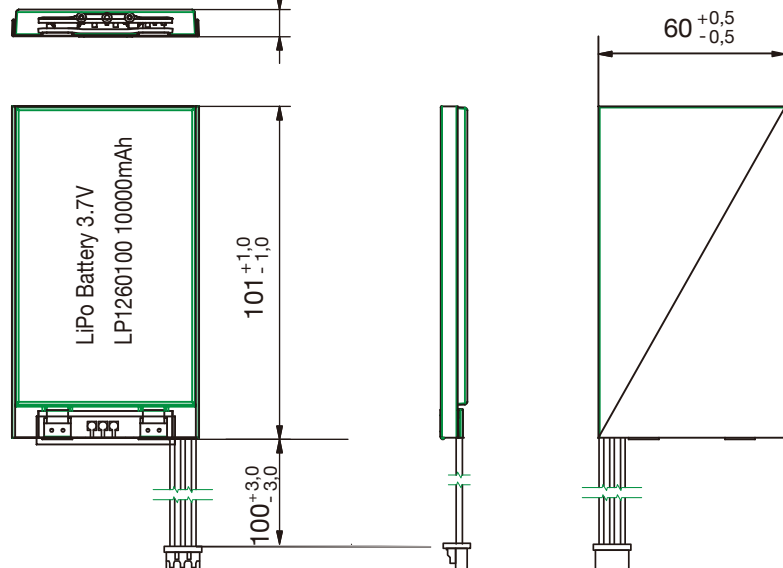
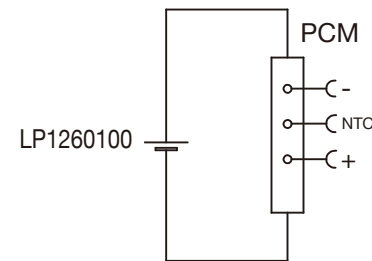

| | | | | | | | |
|--|---------------------------------------|------------------------|--------------------------|------------------------|---|-------|--------------|
| Mae in mm All dimensions in mm | Freimatoleranzen Generaltoleranzen | Date | Name | + LiPol Battery | Zchnng. / Dwg. Nr. 1 FD_5424_10 | Index | |
| Als Betriebsgeheimnis anvertraut, alle Rechte vorbehalten | up to 6 · 0,1 | Erst. / Orig | 05.12.2021 | | | | Xie Qingfang |
| Proprietary data, company confidential, all rights reserved. | over 6 up to 30 · 0,2 | Gepr./Check | 05.12.2021 | | | | Guo Daxia |
| | over 30 up to 100 · 0,3 | Benennung/ Designation | LP1260100 | | | | |
| | over 100 · 0,5 | Origin: | support@lipolbattery.com | | www.LiPolBattery.com | | |